

Historic Wahpeton Soup Walk

- 24. Home of Mr. and Mrs. O. A. Leach, residents since 1896.
- 25. J. E. Morris home, built in 1881.
- 26. Home of Judge W.S. Lauder, an attorney and member of the convention which drew the constitution for the state of North Dakota.
- 27. W. D. Henry home. Henry was a banker and his wife a relative of Herbert Hoover.

- 16. Company I Building. Co. I was organized on May 3, 1897.
- 17. Site of the home of Porter J. McCumber. Elected to the U.S. Senate in 1899.
- 18. First Congregational Church, 1881. The first church in Wahpeton.
- 19. Foss Methodist Church, 1885.
- 20. Richland County Courthouse. Built in 1882, burned in 1883, re-built in 1884 and used until 1912 when the present Courthouse was built on the site.
- 21. Trinity Episcopal Church, 1882.

- 22. R.J. Hughes home, built in 1884.
- 23. Site of the Lutheran Bible School (1904-22) and later St. Mary's Hospital (1922-51).

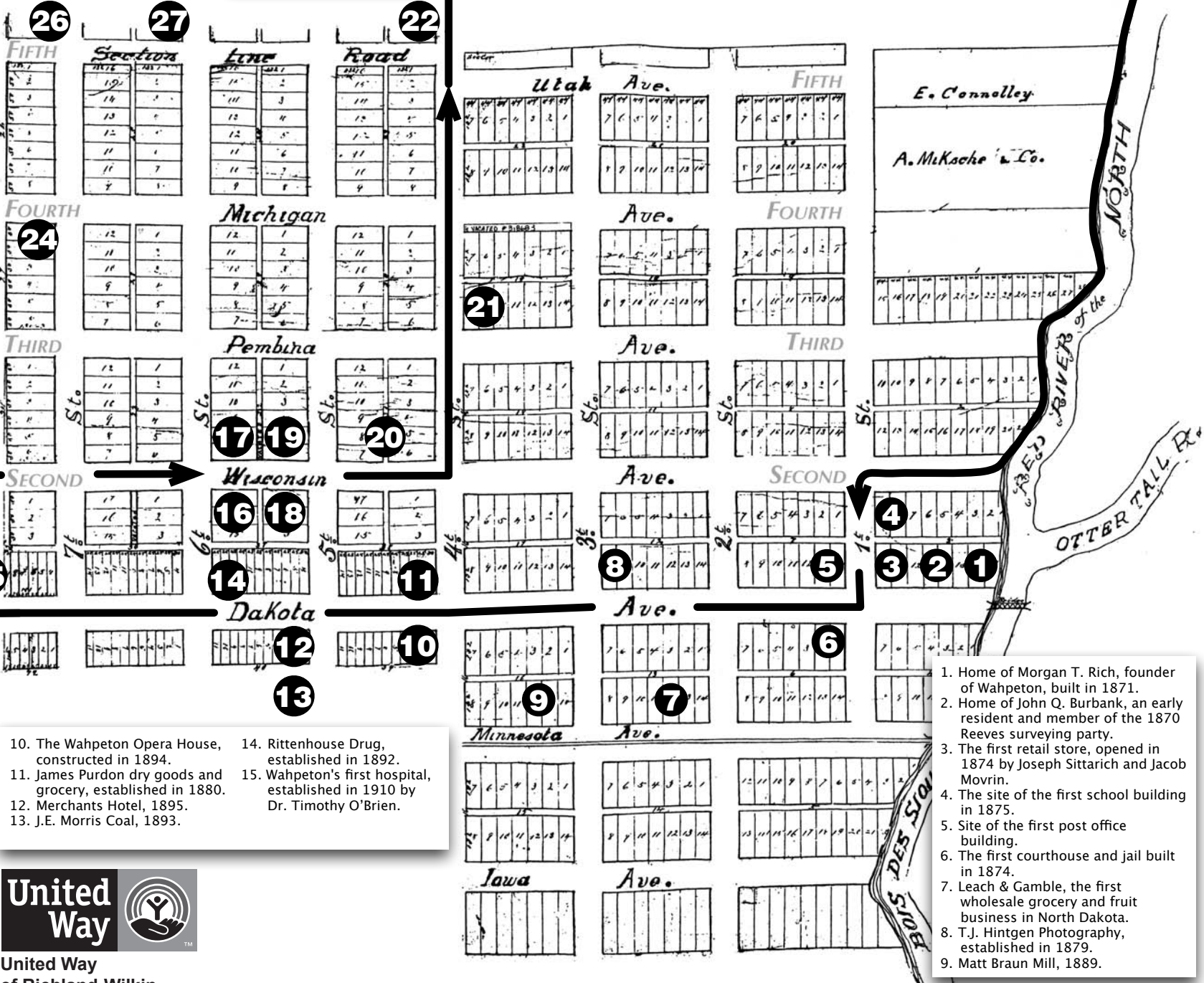

- 10. The Wahpeton Opera House, constructed in 1894.
- 11. James Purdon dry goods and grocery, established in 1880.
- 12. Merchants Hotel, 1895.
- 13. J.E. Morris Coal, 1893.
- 14. Rittenhouse Drug, established in 1892.
- 15. Wahpeton's first hospital, established in 1910 by Dr. Timothy O'Brien.

- 1. Home of Morgan T. Rich, founder of Wahpeton, built in 1871.
- 2. Home of John Q. Burbank, an early resident and member of the 1870 Reeves surveying party.
- 3. The first retail store, opened in 1874 by Joseph Sitarich and Jacob Movrin.
- 4. The site of the first school building in 1875.
- 5. Site of the first post office building.
- 6. The first courthouse and jail built in 1874.
- 7. Leach & Gamble, the first wholesale grocery and fruit business in North Dakota.
- 8. T.J. Hintgen Photography, established in 1879.
- 9. Matt Braun Mill, 1889.





Historic Wahpeton Soup Walk

* Denotes in-ground historic marker

Morgan T. Rich, often called the founder of Richville, Chahinkapa, Wahpeton, was born in Albinia, NY. As a young man he moved to Red Wing, MN, to farm. In was there that he met and married Elizabeth Friederick. Morgan wanted to enlist for duty in the Civil War, but had eye problems that kept him out. In 1864 he visited the Red River Valley on his way to Helena, MT, to the gold mines. He returned to the Valley on his way back to Red Wing in 1868. He returned in 1869 and was so impressed with the Dakota Territory that he stayed in a dugout (cave with boards and skins) on the riverbank and staked out his land. He purchased about 169 acres from the U. S. government. Mr. Rich died in 1898. He spent half his life in Wahpeton.

1. Morgan T. Rich home

Location: Dakota Avenue near the river

The first home was a 14' x 18' log home with 2 rooms, an attic, and a 12' x 18' lean-to. In 1871 he sent for his family who were still living in Red Wing—wife Elizabeth and 3 daughters. Caroline was the oldest and spent a great deal of her youth as a student at the state school for the blind in Faribault, MN (she also taught there); Helen, who later married Judge Freeman Orcutt; Sara, who later married Charles Fred Falley. Fittingly, the first name for the town site was Richville, based upon the founder's name and the fact that the land was so rich for farming. Mr. Rich started a ferry service across the Bois de Sioux in 1871. It was operated by the Rich girls when their father was away.

2. John Q. Burbank home

Location: Directly west of the Rich home

John Q. Burbank was another early citizen. He was part of the survey team that the government sent here to define township borders for the Dakota Territories. He also saw the possibilities of the area and stayed here, purchasing land for farming.

3. Sittarich Movrin store

Location: Dakota Avenue and 1st Street (Uptown Car Wash)

The first retail store was opened in 1874 by Jacob Movrin and Joseph Sittarich. Just a few weeks after the opening the store, Mr. Movrin was struck and killed by lightning as he was washing the store windows. His business partner kept the store operating.

4. First school building

Location: 1st Street and 2nd Avenue North (southeast corner)

In 1875 a one room school building was constructed. There were 12 students taught by Mary Keating. Prior to this, the schooling was in the home of the Blanding family.

J. W. Blanding—father of the community, perhaps because he and his large family were very active in the establishment of the city and its government, education, and church, arrived from WI. He was in real estate. The first educational classes as well as the first church services were held in the Blanding home.

5. First post office building

Location: Near the Sittarich Movrin store

Folsom Dow was an early citizen, coming in 1871 from Yankton, SD. He was a lawyer and served as the first postmaster. He was also the “law” and served in many community and county capacities, including justice of the peace, and as such performed the first wedding in the county.

6. First courthouse and jail

Location: Dakota Avenue, a block west of the river

The first building for city business was built in 1874 by Mr. Rich and Mr. Burbank. It served as the court house and city jail. Morgan T. Rich, John Q. Burbank, and J. W. Blanding served as the first county commissioners.

7. Leach & Gamble

Location: Parking lot behind the Vet's Club

O. A. Leach and E. R. Gamble moved here from Fargo in 1896 and established the first wholesale grocery and fruit business in North Dakota in a frame building on 4th Street. About 1900 they built a brick building located where the parking lot behind the Vet's Club now stands. On the Dakota Avenue side of the block were the Adolph Bessie Land Office, Braun Implement, and the Farmers and Merchants Bank.

On the north side of the street is St. John's Catholic Church, constructed in 1896.

8. T. J. Hintgen Photography

Location: Corner of Dakota Avenue and 3rd Street North (vacant lot on the NE corner of the intersection)

T. J. Hintgen was born in Germany and arrived in Wahpeton in 1879, establishing a photography studio. Later this was the site of Hintgen & Karst Electric. The Hintgen home is now the rectory for St. John's Church. T. J.'s sons, Ray and Herb, were inquisitive youth and had a home-made wireless radio, which was operated by telegraph, in the basement. They later designed a radio and in 1923 build a broadcasting station called station WMAW. It was the second radio station in the state. Henry Kraker was the disc jockey and his sister Sophie Kraker played the piano. Later Henry operated Kraker's Stage Bar where the Oasis Bar is presently located.

To the west of the Hintgen building was the Voves brother's store, which began as a cigar store and later became Voves Grocery. Also in that block were the Hodel Tin Shop and Aspinwall Real Estate.

9. Matt Braun Mill

Location: Site of the present elevator, south of Northcoast Tanning

Bonanza farming developed in the 1880s. With all the raising of grain, there arose a demand for a means on processing it nearer to home. In 1881 Busch & Company built a grist mill in Wahpeton. This now meant that the farmers no longer had to haul their grain to Elizabeth, MN, or other points. The mill at Wahpeton was acquired by Braun Brothers & Eckes in 1889 and located at the site of the present elevator.

On the Dakota Avenue side of that block was Peterson Livery and the Columbia Saloon and Restaurant.

10. Opera House

Location: 403 Dakota Avenue, present site of Snap Fitness

The Opera House was constructed completely by hand in 1894 at a cost of \$20,000. The bricks of the Opera House were moved by hand as the workmen formed a line from the depot to the building site and handed stacks of bricks to each other. The seating capacity was 800. There were four main areas for seating: the Parquet had richly upholstered seats in front at a cost of \$1.50 each; \$1.75 seats; \$.50 cent seats; and wooden benches for \$.25 cents.

11. James Purdon Dry Goods and Grocery

Location: Dakota Avenue and 4th Street North, northwest corner (now a vacant lot)

Directly across the street from the Opera House was the James Purdon Dry Goods and Grocery. James Purdon was born in 1840 in Ontario, Canada. He moved to Alexandria, MN, in 1868 and to Wahpeton in 1880. The Purdon family lived directly above the store. Next door was the Willardt Meat Market, Lounsbury Furniture, a harness shop, and the Northwestern Bank, which later became the National Bank (and is now the site of the art gallery). Also in that block is the Swank Building (part of Heritage Hallmark). Dan Swank came to Wahpeton in 1890 from Anoka, Minnesota, to work in a butcher shop. He started Swanks Confectionary, a soda fountain and ice cream parlor, in 1895.

Look across the street to the present JC Penney building. Wahpeton's first architect came to this area in the early 1880s. Brothers Eugene and Gustav Schuler came here from Milwaukee, WI, and formed "Schuler Brothers", a firm which sold Deering farm machinery. After selling their machinery business, the two incorporated the Northwest Construction Company. Eugene, the architect, built some of this area's better known buildings, including St. John's Catholic Church, the post office, and the sheriff's home and jail. In 1897 the Schuler Building was built on Dakota Avenue. The Schuler name can still be seen on the JC Penney building.

12. Merchants Hotel

Location: 501 Dakota Avenue

The Merchants Hotel, built in 1895, was at the site of the present Bank of the West. Robert N. Mitton, proprietor, was born in Winona, Minnesota, and came to Wahpeton with many years of hotel business experience. The hotel was described in 1900 as "the pride of the town. It was the only first-class hotel in the city. It was large and roomy, finished in hardwood, steam heated, electric lighted, had

hot and cold baths, electric call bells, and was well furnished throughout. The cuisine was equal to that of any hotel in the northwest, and guests received the very best service." Next door to the hotel were the Beehive Store and Meyers Saloon.

13. J.E. Morris Coal Company

Location: South of Bank of the West

To the south of that block was the J. E. Morris Coal Company, established in 1893 and originally located in Rich Park, just west of the new Community Center. The Coal Company moved to its last location in 1914.

14. Rittenhouse Drug

Location: 522 Dakota Avenue

Corner Drug is the site of the C. D. Rittenhouse Drug Store, established in 1892. Look back to the east and imagine the original Stern Clothing store in the middle of the block, Lacy Jewelry Store (later Olson Jewelers) next to it, and Forkner Brothers grocery on the corner.

Looking south and west, you would see First National Bank, later called the People's Bank, located where the Daily News offices are now. Speaking of newspapers, did you know that Wahpeton boasted 3 newspapers at one time? The first one, The Richland County Gazette, was started in 1878 by Mr. Borgen, and sold the next year to E. K. Morrell, who ran it until 1902.

G. P. Garret established The Times, the city's second newspaper, in 1882.

In 1886 another newspaper, The Wahpeton Globe, published by H. W. Troy, appeared. It was known briefly as The Dakota Globe. Fred Falley, its longtime editor, also served as secretary of state for North Dakota from 1896 to 1900.

In 1907 R. J. Hughes, who had purchased The Richland Gazette from Morrell in 1902, joined Fred Falley, owner of The Wahpeton Globe, in organizing the Globe Gazette Printing Company and consolidated the two newspapers under one title, Globe Gazette. The Globe Gazette building can still be seen today next to Corner Drug.

15. Wahpeton hospital

Location: 720 Dakota Avenue

In 1888 Dr. Timothy O'Brien came to Wahpeton from Canada. In 1910 he established a hospital at 720 Dakota Avenue. His wife served as nurse, cook, anesthetist, and

all around helper in the hospital. Dr. O'Brien and J. P. Reeder, a banker, had the first horseless carriages in Wahpeton.

Remember: this was the edge of town. Houses did begin to appear, but they were few and far between.

16. Company I building

Location: 2nd Avenue and 6th Street North (SE corner)

Company I of the First North Dakota National Guard was organized on May 3, 1897. Only one year later they joined the First North Dakota Regiment and were assigned to service in the Philippines during the Spanish-American War. The company spent 18 months overseas, returning to Wahpeton in 1899 with a loss of only two men—one killed in action and the other having died in Nagasaki, Japan, on the way home.

17. Porter J. McCumber home *

Location: 524 2nd Avenue North (Job Service)

The home of Porter J. McCumber, elected to the U. S. Senate in 1899, was located where the Job Service offices are now. Senator McCumber came to Wahpeton in 1881 to practice law. He was influential in the establishment, in 1904, of the Wahpeton Indian School (now Circle of Nations).

18. Congregational Church *

Location: Town Centre Square Parking Lot

The intersection of 5th Street and Wisconsin (2nd Avenue) was the site of two early churches—the Congregational Church (1881) on the southwest corner and the Methodist Church (1885) on the northwest corner. The Congregational Church was the first protestant church in Richland County. Prior to that, church services were held either in resident's homes or in the train depot in Breckenridge.

19. Foss Methodist Church *

Location: 502 2nd Avenue North (U S Bank)

20. Richland County courthouse

Location: 418 2nd Avenue North

The Richland County Courthouse was built in 1882 on land donated by Morgan Rich. Unfortunately, the building burned in 1883. A new building was constructed the

next year and used until 1912 when it was razed to make way for the present Courthouse.

Across the street to the south is the Leach Public Library, built in 1923. This Library was a gift of Mr. and Mrs. O. A. Leach.

21. Trinity Episcopal Church *

Location: Corner of 4th Street and 3rd Avenue North (northeast corner)

Trinity Episcopal Church was built on this site in 1882 and continued here until 1963 when a new church was built at the corner of 4th Street and 16th Avenue North.

22. R. J. Hughes home *

Location: Corner of 4th Street and 5th Avenue North (northwest corner)

No journey through Wahpeton would be complete without the inclusion of R. J. Hughes, "Mr. Wahpeton." Mr. Hughes came to town with his parents and maternal grandmother in 1883. When the Hughes house was built in 1884, Mr. Hughes said that they had to have their water hauled in before there was electricity and running water. Not many people had wells, so those who did sold water by the barrel. They hauled it to the houses on a stone boat behind a team of horses. Nearly everyone who had to buy water had a barrel on the back porch. Behind the house was a barn for the team of donkeys and a cow and some chickens. When Mr. Hughes Sr. died, Robert was 21 years old. He had attended the Red River Valley University but now started to sell bicycles. This business developed and made their living for several years. In 1939 Robert met Laura Taylor at the New York World's Fair. They married in 1943 and together founded Rosemeade Pottery in Wahpeton. Mrs. Hughes died in 1959 and Mr. Hughes continued to reside in the family home until the last year of his life.

23. Lutheran bible school * St. Mary's Hospital *

Location: Leach Home block (4th Street and 7th Avenue North)

This block was the location of the Lutheran Bible School from 1904-1922. The Wahpeton Hospital, later St. Mary's Hospital, stood here from 1922 to 1951. This was also the site of the Carmelite Monastery until they moved to their present location west of Wahpeton.

This concludes the Soup Walk. Please return to the Chahinkapa Park chalet to complete the two mile loop. The following historic homes are not included in the course, but may be visited at your own convenience.

24. O.A. Leach home

Location: 323 7th Street North

25. J.E. Morris home

Location: 505 8th Street North

This home was built in 1881 by John D. Rockefeller I for his cousin Ellen Seeley who came to Dakota Territory in 1881 to establish residency for a divorce. The Morris family moved into the home in 1899. Miss Mercedes Morris, daughter of J.E. Morris, still resides in the family home.

26. Judge W. S. Lauder home

Location: 505 7th Street North

This large brown apartment building was once the home of Judge W. S. Lauder, who came here in 1880. Judge Lauder was a member of the convention that drafted the constitution for the State of North Dakota.

27. W. D. Henry home

Location: 501 6th Street North

This apartment building was the home of W. D. Henry, an early banker. It is reported that President and Mrs. Hoover visited the Henrys on their honeymoon in 1901. Mr. Henry was Mrs. Hoover's uncle. Mrs. Hoover made frequent trips back to visit, but always without Secret Service men, as she didn't want undue publicity.